

Capacitor Application Requirements

Attention: Electrocube Customer Service Representative Email: esales@electrocube.com
 Sales Rep/Distributor: _____ Date: _____
 Rep/Dist. Contact: _____ Tel: _____ Fax: _____
 Customer Name: _____ Contact: _____
 Address: _____ Tel: _____
 City: _____ State: _____ Zip: _____ Fax: _____
 Email: _____

Style of Capacitor Required:

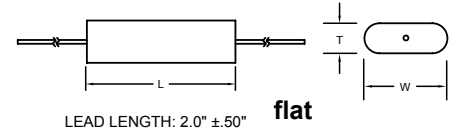
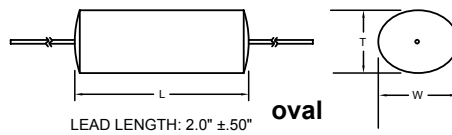
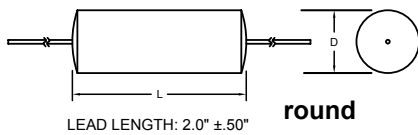

Axial Lead - Wrap & Fill

Dimensions: L: _____
 D: _____

Axial Lead - Wrap & Fill

Dimensions: L: _____
 W: _____ T: _____

Axial Lead - Wrap & Fill

Dimensions: L: _____
 W: _____ T: _____

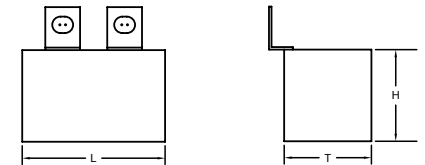
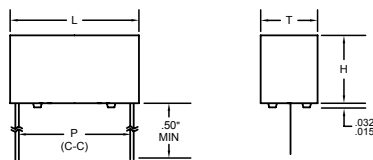
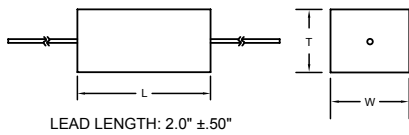

Axial Lead - Epoxy Case

Dimensions: L: _____
 T: _____ W: _____

Radial Lead - Epoxy Case

L: _____ T: _____
 P: _____ H: _____

IGBT - Epoxy Case

Dimensions: L: _____
 H: _____ T: _____

Metallized Dielectric:

Polyester (mylar) 230 Series Polyphenylene Sulfide 330 Series 340 Series
 Polypropylene 926 Series 935 Series 945 Series 958 Series

Film/Foil Dielectric:

Polyester/foil 250 Series Polypropylene/foil 950 Series Other: _____

Teflon®/Foil Dielectric: 433D Series

Metallized Teflon® Dielectric: 463D Series

Metallized Combination Dielectric: 730 Series 732 Series 744B Series

Capacitance value (MFD) _____ Tolerance: _____ % Voltage: _____ AC _____ DC

Wave Form: _____ Frequency: _____ Temperature Range: _____ Application: _____

Burn-in required: Yes No Packaging: Bulk Tape and Reel Ammo Pack

Present Supplier: _____ P/N: _____ Spec./Dwg. enc. _____

Current Quantity Requirement: _____ Annual Requirement: _____

Competitor's Purchase Price: _____ Customer Expected Price Range: _____

Special Instructions and Comments: _____

Submit completed form [here](#)